

1/4-14 Type B Self-tapping Metal to Metal Fastener

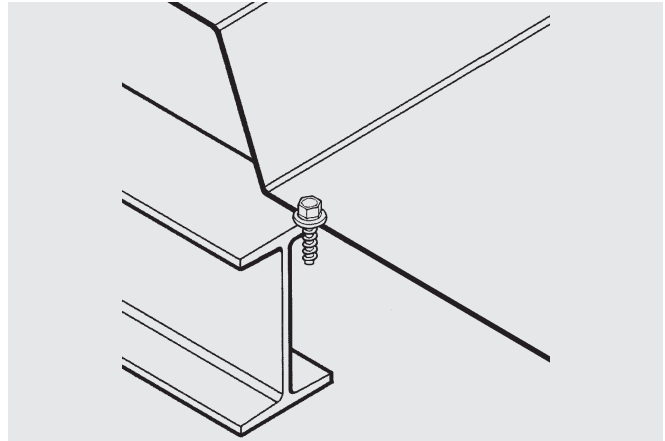

Features and Benefits

- Zinc plated carbon steel
- Available with no sealing washer or with bond seal washer
- Long lengths available for specialty applications

Application

Metal panel to medium and heavy gauge metal applications

Product Selection

Material No.	Fastener Length	Thread Length*	Description	Carton Wt. (lbs.)	Carton Qty.
784198	3/4"	Full	TB-#14x3/4-H3/8-GB19/32	39	2,500
784208	1"	Full	TB-#14x1-H3/8-GB19/32	44	2,500
784232	1-1/2"	Full	TB-#14x1-1/2-H3/8-GB19/32	44	2,000
784241	2"	Full	TB-#14x2-H3/8-GB19/32	38	1,500
784248	2-1/2"	Full	TB-#14x2-1/2-H3/8-GB19/32	30	1,000
784253	3"	2-7/8"	TB-#14x3-H3/8-GB19/32	35	1,000
784258	3-1/2"	2-7/8"	TB-#14x3-1/2-H3/8-GB19/32	37	1,000
784262	4"	2-7/8"	TB-#14x4-H3/8-GB19/32	21	500
784268	5"	2-7/8"	TB-#14x5-H3/8-GB19/32	26	500
784273	6"	2-7/8"	TB-#14x6-H3/8-GB19/32	28	500

Plain product bulk carton packed, unless otherwise noted.

*Note – Thread length measured from tip of point to top of the threads.



1/4-14 Type B Self-tapping Metal to Metal Fastener

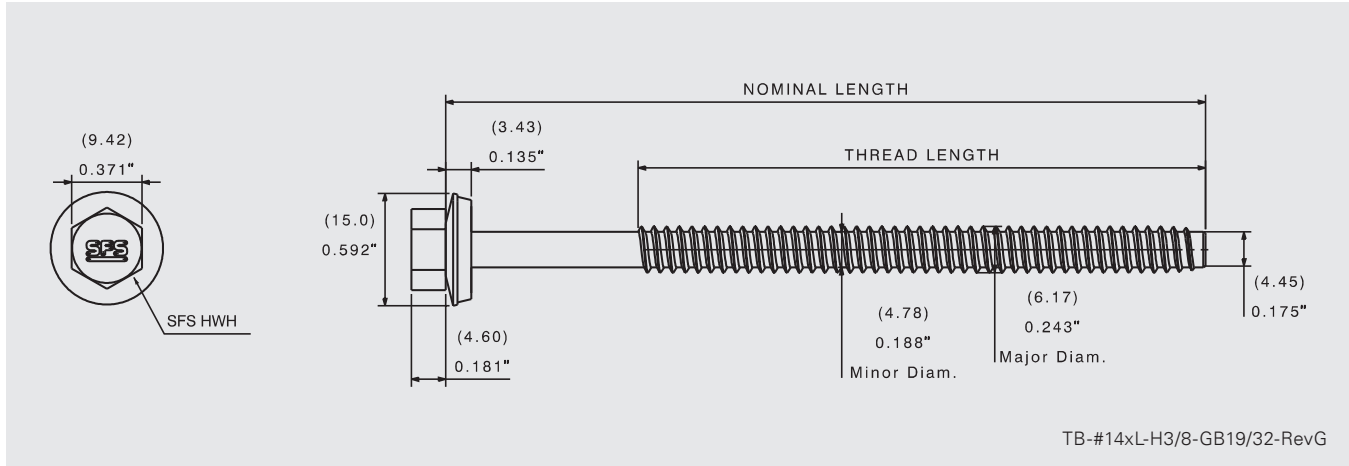

Product Specifications

Diameter: 1/4" (6.17 mm)
 Threads Per Inch: 14
 Head Style: 3/8" dia. HH AF (9.42 mm)
 Washer: 19/32" galvanized and EPDM bond seal (15 mm)

Drill Point: Type B
 Drill Capacity: 0.044"–0.500" (1.12 mm–12.7 mm)
 Thread Major Dia: 0.243" (6.17 mm)
 Thread Minor Dia: 0.188" (4.78 mm)

Performance Data^{1,2,3}

Material Strength

Tensile	3800 lbf / 16903 N
Shear	2560 lbf / 11387 N
Torsional	142 lbf·in / 16.04 N·m

Pull Out Strength Steel

16 Ga (1.5 mm)	879 lbf / 3910 N
14 Ga (1.9 mm)	1277 lbf / 5680 N
12 Ga (2.7 mm)	2185 lbf / 9719 N

Pull Over Strength Steel

26 Ga (0.5mm)	616 lbf / 2740 N
24 Ga (0.6mm)	884 lbf / 3932 N
22 Ga (0.8mm)	1079 lbf / 4799 N

¹ Pull out values are based on 45 ksi cold formed sheet metal.

² SFS [5625.19, 4812.11]

³ S-120, SC3

Installation and Application Considerations

Tools: 0–1000 rpm screw gun equipped with depth sensing nose piece.

Use of impact guns or hammer drills is not recommended.

Metal thickness	Drill bit size
0.065"–0.085" (1.65 mm–2.16 mm)	#8 (5.05 mm)
0.085"–0.115" (2.16 mm–2.92 mm)	#7 (5.11 mm)
0.115"–0.375" (2.92 mm–9.53 mm)	#1 (5.79 mm)
0.375"–0.500" (9.53 mm–12.7 mm)	#1 or larger depending on hardness of steel

The hole size determines installation performance and pull out strength. Thickness is based on normal, single thickness purlin/girt or multiple material thickness combined for total.

Fastener length should provide for a minimum of 3/16" penetration of fully developed threads into metal substrate.

US
 T 800 234 4533
 www.sfsintecusa.com

Canada
 T 866 847 5400
 www.sfsintec.ca

Metric values are approximate conversions.

The details stated are results of tests and/or calculations and therefore are non-binding and do not represent warranties or warranted characteristics for not specified applications. All calculations therefore have to be checked and approved by the responsible planner ahead of execution. The user is responsible to assure compliance with all applicable laws and regulations.